



IELTS LISTENING

NaNasensei
MAP+流程图

不加密雅思请加微信:susuyasi02



请扫描二维码



做留学生的追梦引路人



MAP

直播6

不加密雅思请加微信:susuyasi02



请扫描二维码



做留学生的追梦引路人

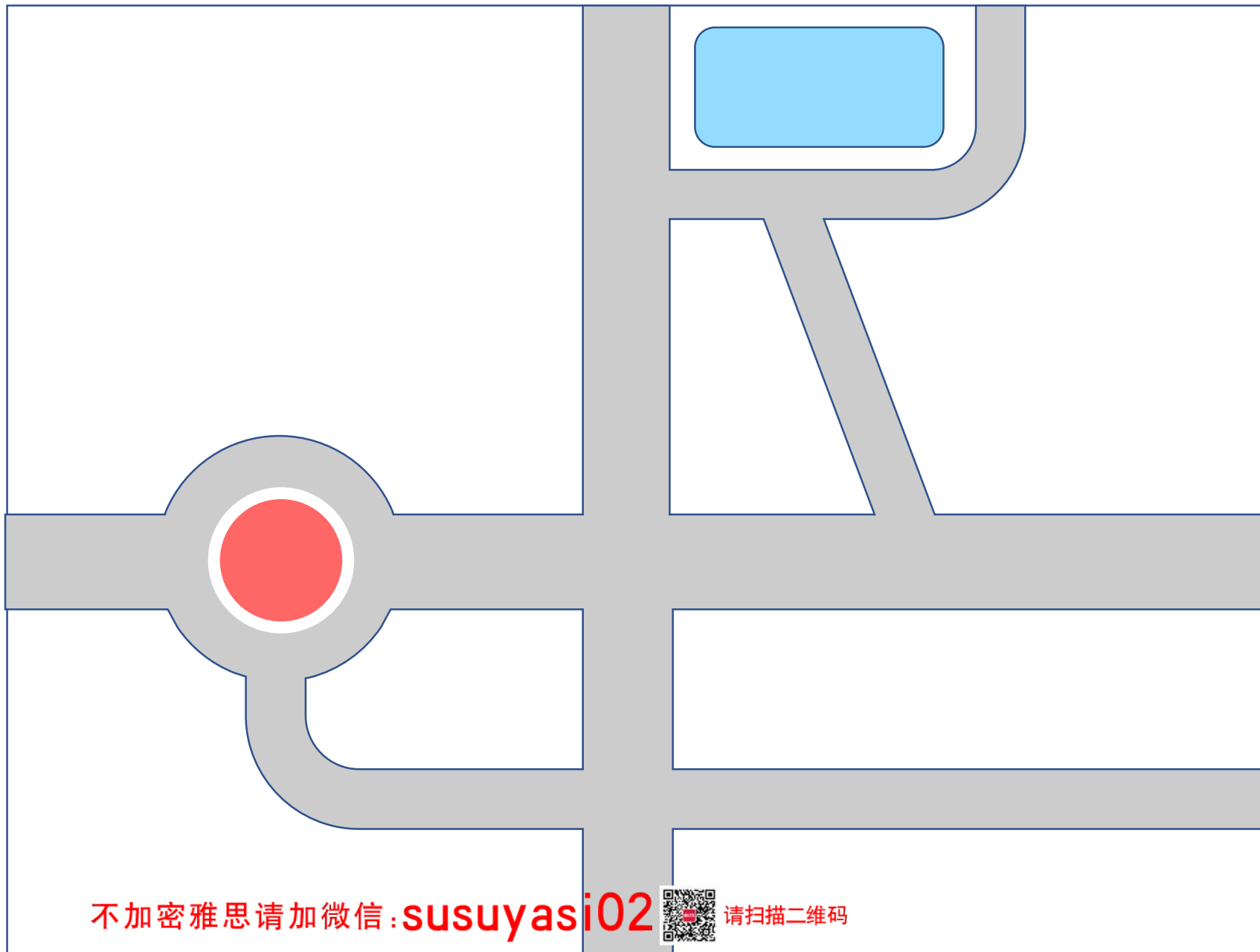

不加密雅思请加微信:susuyasi02 请扫描二维码

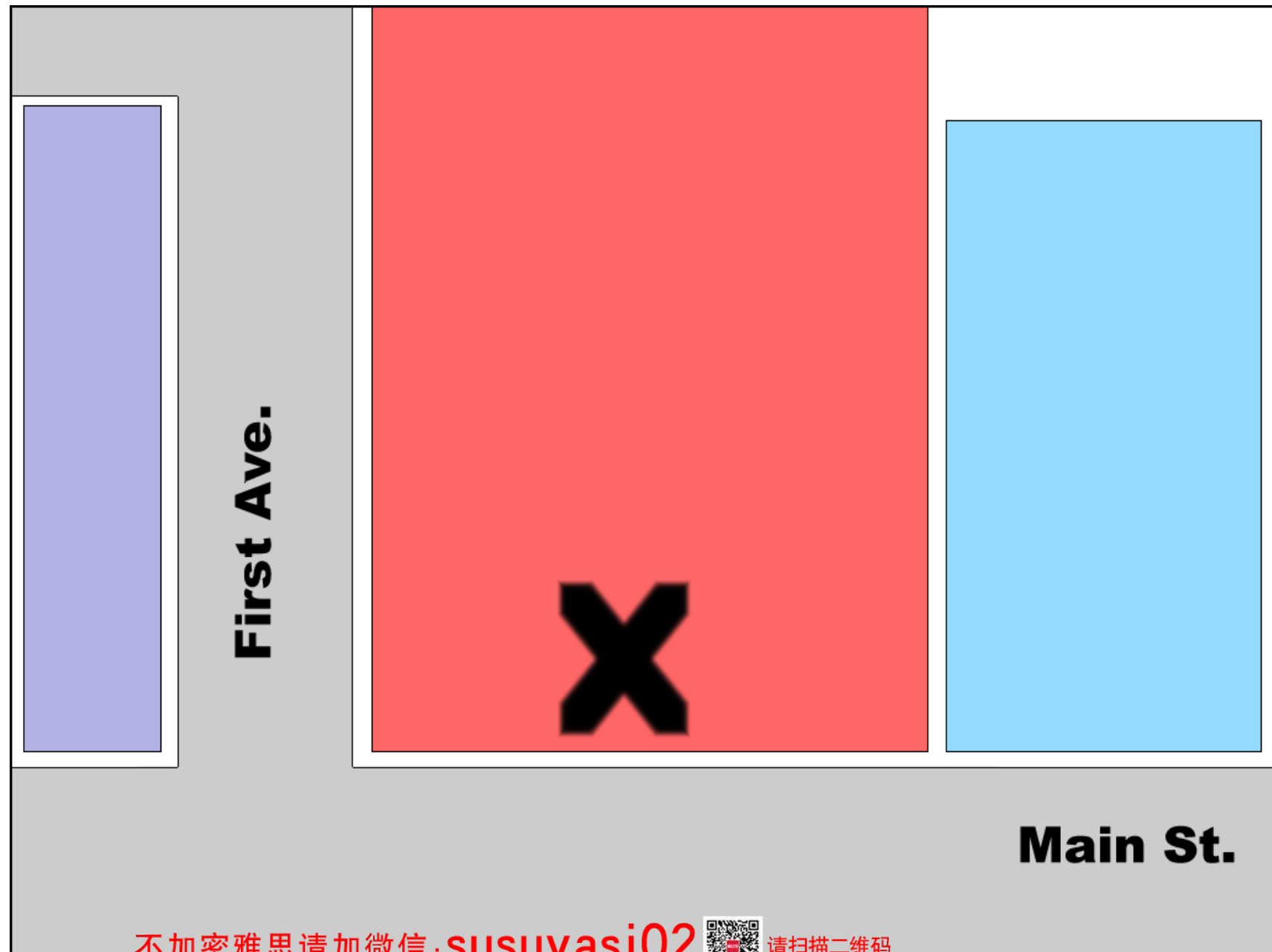

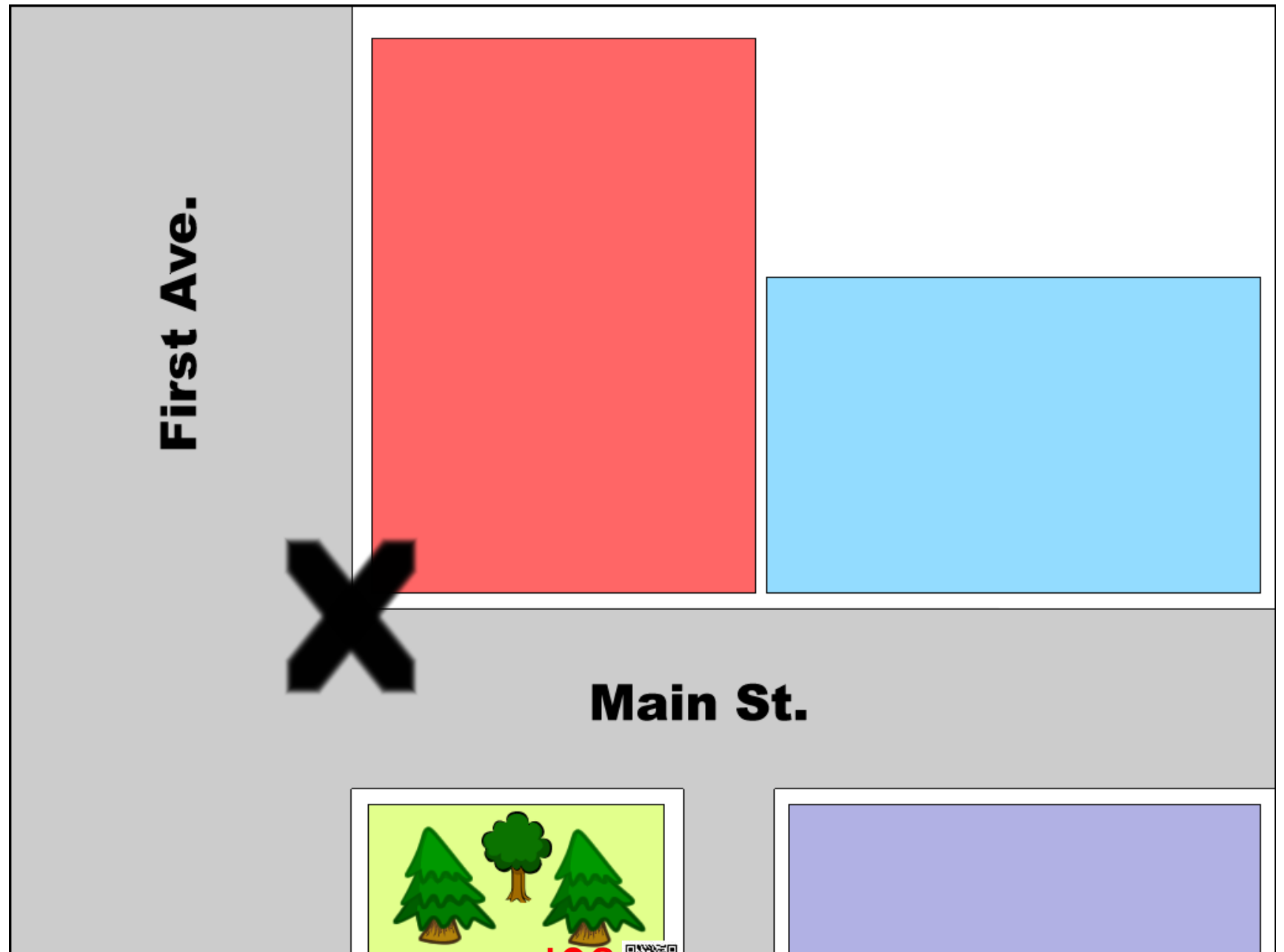

不加密雅思请加微信:susuyasi02



请扫描二维码

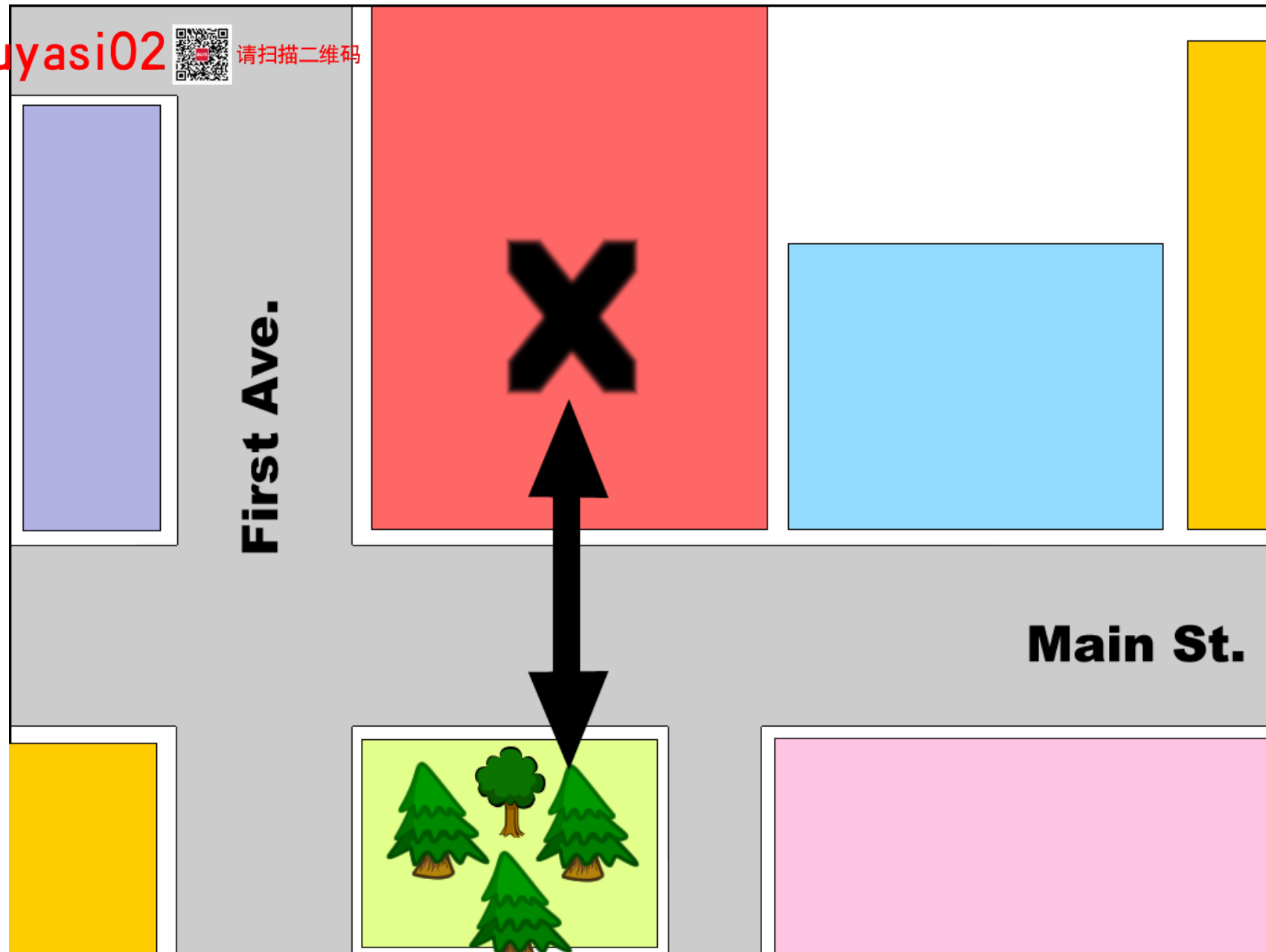

across from

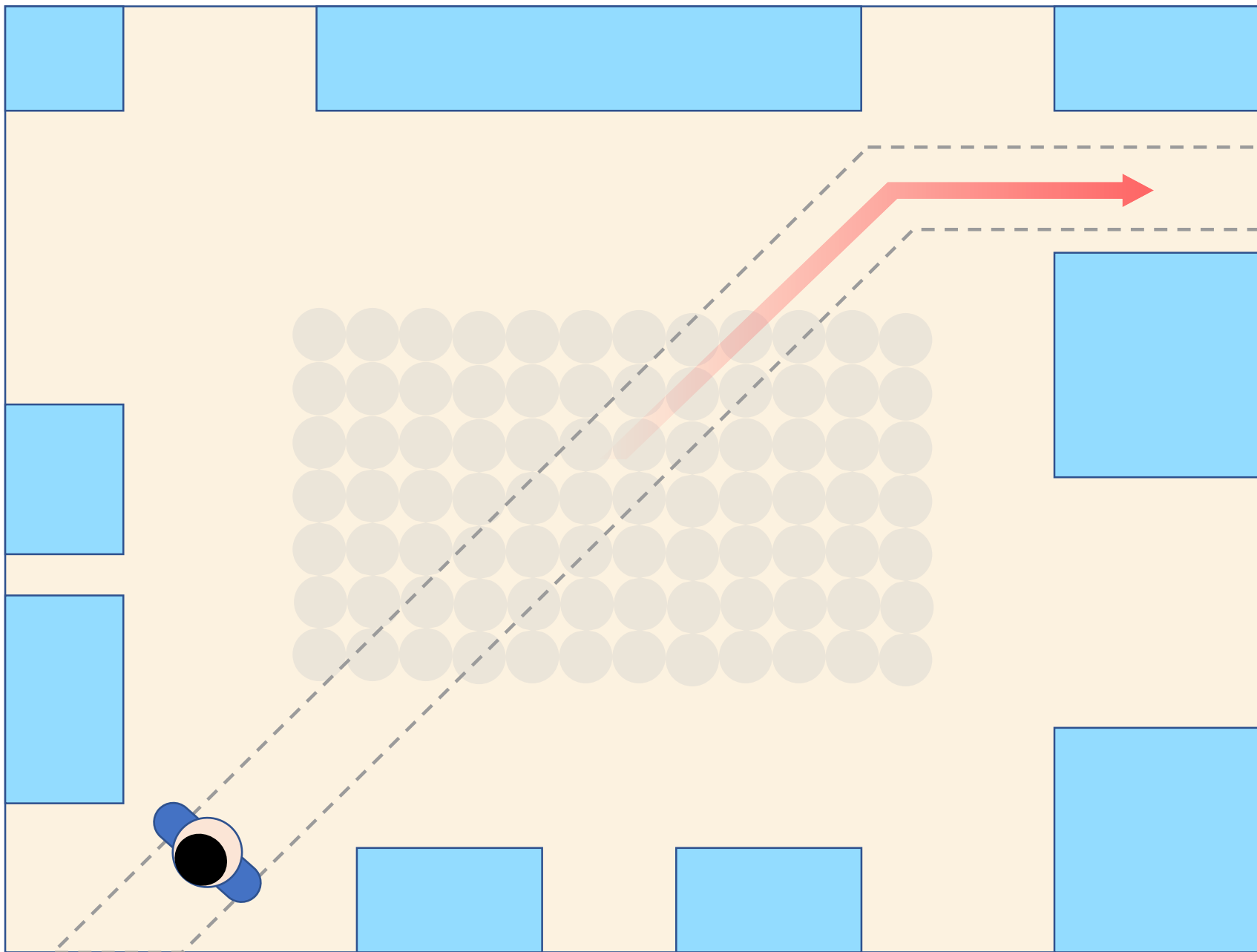

Ground floor plan of theatre

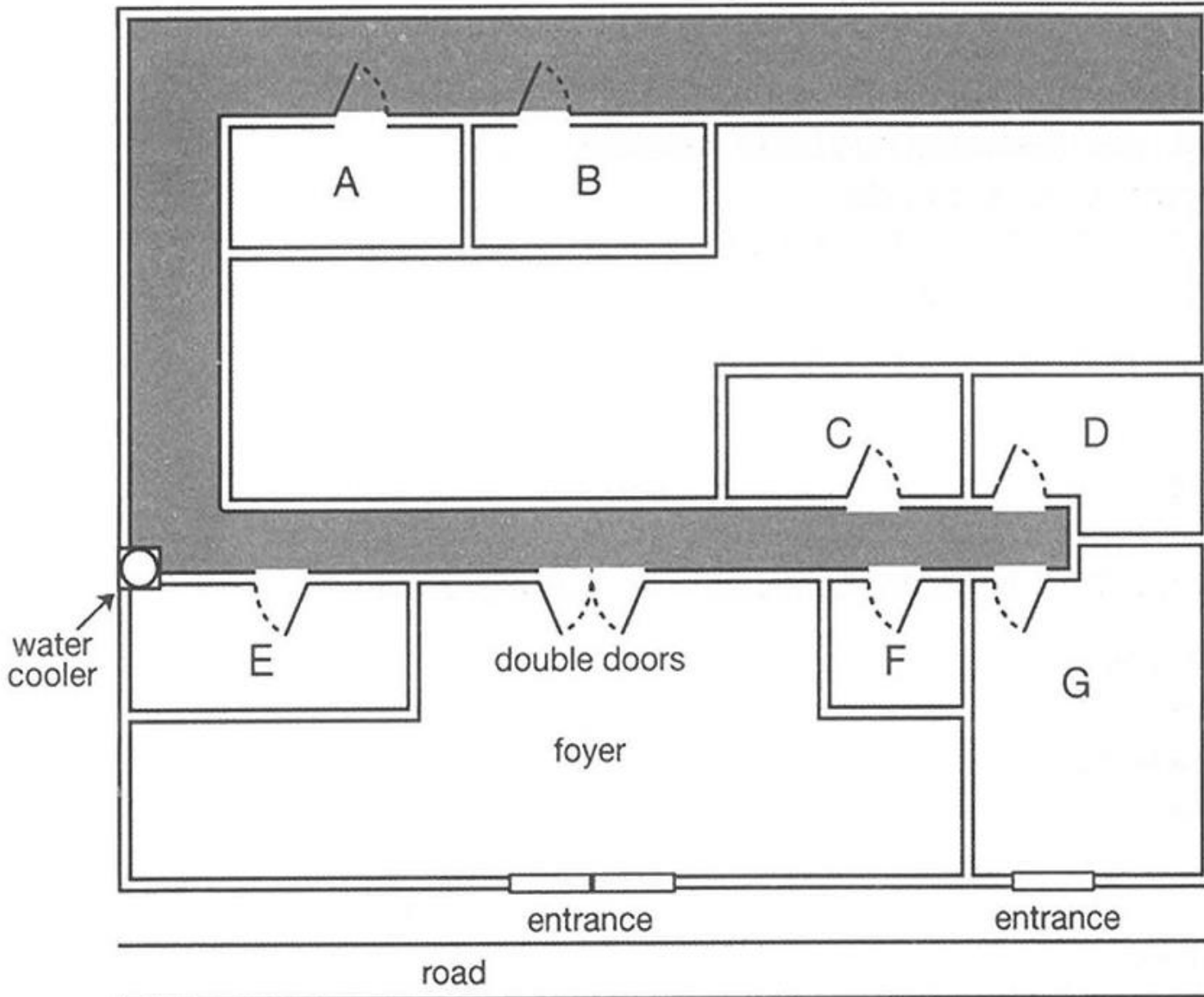

17 box office

18 theatre manager's office

19 lighting box

20 artistic director's office

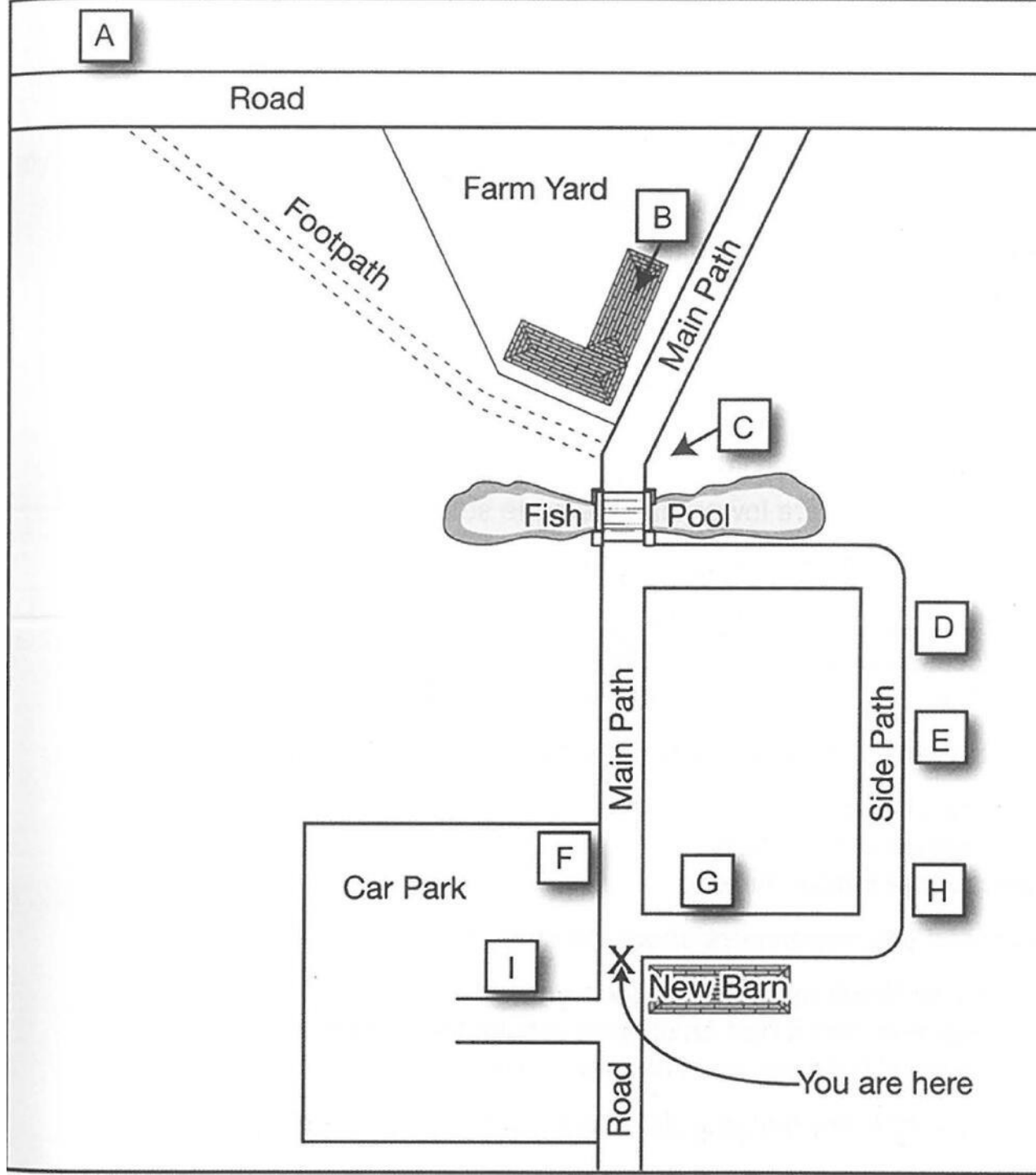

15 Scarecrow

16 Maze

17 Café

18 Black Barn

19 Covered picnic area

20 Fiddy House

不加密雅思请加微信: **susuyasi02**  请扫描二维码

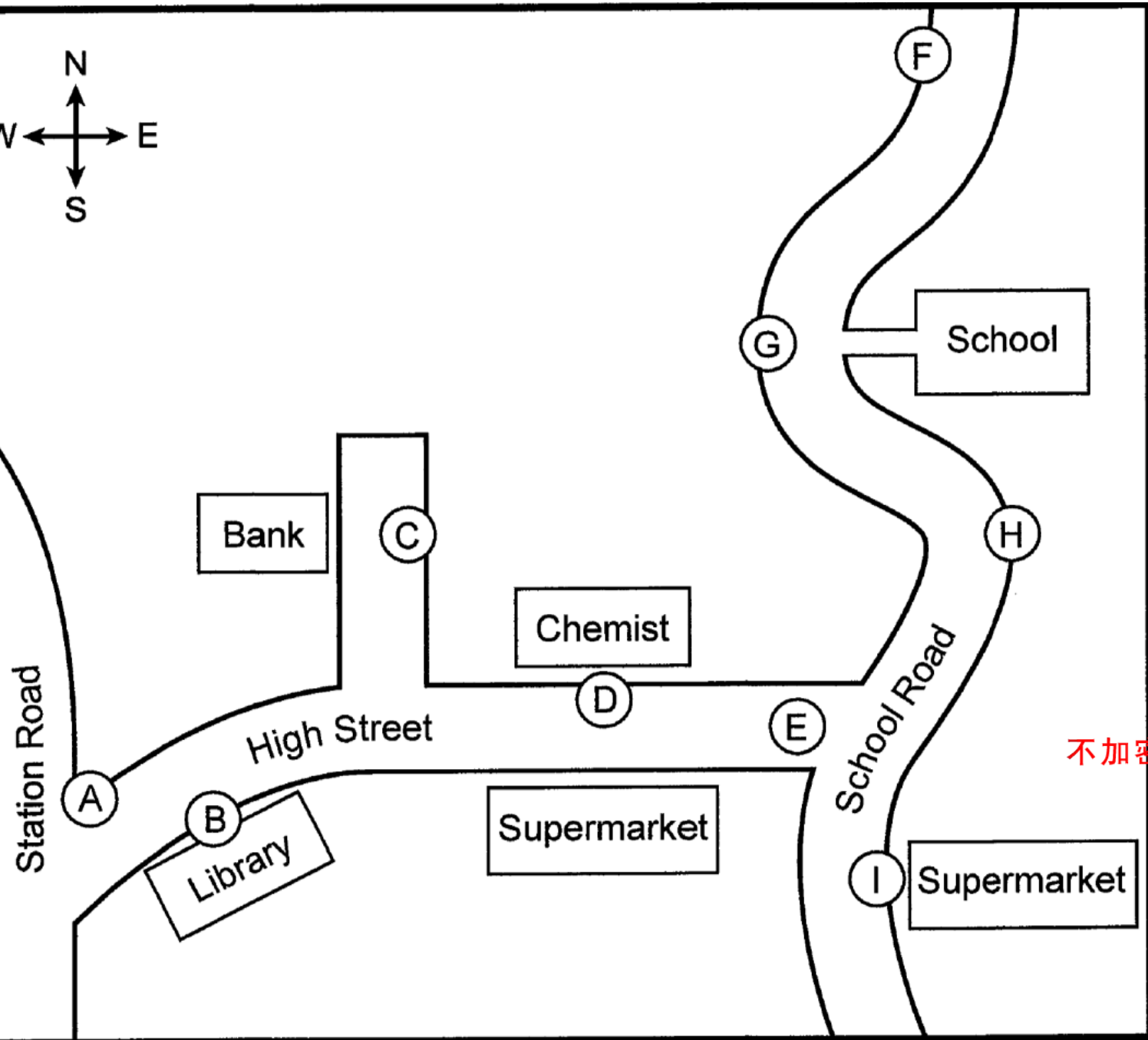
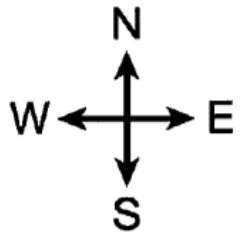

14 New traffic lights

15 Pedestrian crossing

16 Parking allowed

17 New 'No Parking' sign

18 New disabled parking spaces

19 Widened pavement

20 Lorry loading/unloading restrictions

不加密雅思请加微信:susuyasi02  请扫描二维码



流程图

直播6

不加密雅思请加微信:susuyasi02



请扫描二维码



做留学生的追梦引路人

How James will write his paper on the Vikings

He'll read a 26 _____ and choose his topic.



He'll borrow a 27 _____ from Beth.



He'll plan a 28 _____ of the paper.



He'll read some source material and write 29 _____.



He'll write the paper using 30 _____.



He'll write the complete paper.

- A bullet points
- B film
- C notes
- D structure
- E student paper
- F textbook
- G documentary

不加密雅思请加微信: **susuyasi02**  请扫描二维码

A patterns
E employees

B names
F solutions

C sources
G headings

D questions
H officials

RESEARCH

Locate and read relevant articles, noting key information and also **21**
Identify a problem or need

Select interviewees- these may be site **22**, visitors or
city **23**

Prepare and carry out interviews. If possible, collect statistics.
Check whether **24** of interviewees can be used



ANALYSIS

Select relevant information and try to identify **25**
Decide on the best form of visuals



WRITING THE CASE STUDY

Give some background before writing the main sections
Do NOT end with **26**





模考讲解**C10-T3**

录播11

不加密雅思请加微信:susuyasi02



请扫描二



做留学生的追梦引路人

Section 1

Complete the form below.
Write *ONE WORD AND/OR A NUMBER* for each answer.

Early Learning Childcare Centre
Enrolment Form

Example

Parent or guardian: Carol Smith

Personal Details

Child's name: Kate

Age: 1

Address: 2 Road, Woodside, 4032

Phone: 3345 9865

Childcare Information

Days enrolled for: Monday and 3

Start time: 4 Am

Childcare group: the 5 Group

Which meal/s are required each day? 6

Medical conditions: needs 7

Emergency contact: Jenny 8

Phone: 3346 7523

Relationship to child: 9

Fees

Will pay each 10

不加密雅思请加微信:susuyasi02 请扫描



Questions 11 and 12

Choose **TWO** letters, **A-E**.

Which **TWO** things does Alice say about the Dolphin Conservation Trust?

- A Children make up most of the membership.
- B It's the country's largest conservation organization.
- C It helps finance campaigns for changes in fishing practices.
- D It employs several dolphin experts full-time.
- E Volunteers help in various ways.

Questions 13-15

Choose the correct letter, **A, B, or C**.

- 13 Why is Alice so pleased the Trust has won the Charity Commission award?
- A It has brought in extra money.
 - B It made the work of the trust better known.
 - C It has attracted more members.
- 14 Alice says oil exploration causes problems to dolphins because of
- A noise.
 - B oil leaks.
 - C movement of ships.

- 15 Alice became interested in dolphins when
- A she saw one swimming near her home.
 - B she heard a speaker at her school.
 - C she read a book about them.

Questions 16-20

Which dolphin does Alice make each of the following comments about?
Write the correct letter **A, B, C or D** next to questions 16-20.

Dolphins	
A	Moondancer
B	Echo
C	Kiwi
D	Samson

Comments

- 16 It has not been seen this year. _____
- 17 It is photographed more than the others. _____
- 18 It is always very energetic. _____
- 19 It is the newest one in the scheme. _____
- 20 It has an unusual shape. _____

Section 3

Questions 21-25

Choose the correct letter, A, B, or C.

Theatre Studies Course

- 21 What helped Rob to prepare to play the character of a doctor?
A the stories his grandfather told him
B the times when he watched his grandfather working
C the way he imagined his grandfather at work
- 22 In the play's first scene, the boredom of village life was suggested by
A repetition of words and phrases.
B scenery painted in dull colours.
C long pauses within conversations.
- 23 What has Rob learned about himself through working in a group?
A He likes to have clear guidelines.
B He copes well with stress.
C He thinks he is a good leader.
- 24 To support the production, research material was used which described
A political developments.
B changing social attitudes.
C economic transformations.
- 25 What problem did the students overcome in the final rehearsal?
A one person forgetting their words
B an equipment failure
C the injury of one character

Questions 26-30

What action is needed for the following stages in doing the 'year abroad' option?
Choose **FIVE** answers from the box and write the correct letter, **A-G**, next to questions 26-30.

Action

- A be on time
- B get a letter of recommendation
- C plan for the final year
- D make sure the institution's focus is relevant
- E show ability in Theatre Studies
- F make travel arrangements and bookings
- G ask for help

Stages in doing the 'year abroad' option

- 26 in the second year of the course _____
- 27 when first choosing where to go _____
- 28 when sending in your choices _____
- 29 when writing your personal statement _____
- 30 when doing the year abroad _____

Section 4

Complete the notes below.

Write **ONE WORD ONLY** for each answer.

'Self-regulatory focus theory' and leadership

Self-regulatory focus theory:

People's focus is to approach pleasure or avoid pain

Promotion goals focus on 31 _____

Prevention goals emphasize avoiding punishment

Factors that affect people's focus

The Chronic Factor

- comes from one's 32 _____

The 33 _____ Factor

- we are more likely to focus on promotion goals when with a 34 _____
- we are more likely to focus on prevention goals with our boss

How people's focus affects them

Promotion Focus: People think about an ideal version of themselves, their 35 _____ and their gains.

Prevention Focus: People think about their 'ought' self and their obligations

Leaders

Leadership behavior and 36 _____ affects people's focus

Transformational Leaders:

- pay special attention to the 37 _____ of their followers
- passionately communicate a clear 38 _____
- inspire promotion focus in followers

Transactional Leaders:

- create 39 _____ to make expectations clear
- emphasize the results of a mistake
- inspire prevention focus in followers

Conclusion

Promotion Focus is good for jobs requiring 40 _____

Prevention Focus is good for work such as a surgeon

Leaders' actions affect which focus people use



考前tips

考前1周早睡早起，把生物钟调整到早上9点是大脑兴奋期
考试状态真的太重要了，不然大脑会反应比较慢

考试当天进入考场之前推荐听1-2篇听力题目
让大脑进入英语的思维中

不加密雅思请加微信:susuyasi02



请扫描二维码



做留学生的追梦引路人



超常发挥



不加密雅思请加微信:susuyasi02



请扫描二维码



做留学生的追梦引路人